

INVITATION TO TENDER FOR STANDING TIMBER

Barrhill, Dumfries and Galloway

REFERENCE: **Barrhill 2024-1**

Description: Two separate coupes of Sitka spruce planted in 1972 and 1984 amounting to approximately 15,682 tonnes. Both are suitable for mechanised harvesting. A small section of larch felled due to a 2012 SPHN is included in the sale to enable restocking. Watercourses within and adjacent to both coupes are a part of the River Bladnoch SAC. The two felling areas have separate internal forest road accesses leading to a STTS haulage route to Arnimean Bridge and onto the A714.

Timing: Tenders should be **received by 12 noon on Tuesday 23 April 2024**, by email to tenders@greshamhouse.com.

Offers: The contract will be based on a single price per tonne. **Please state your planned start and completion date for the harvesting.**

Location: Cpts 201-206
West of the B7027 at Loch Maberry, South Ayrshire
OS 1:50,000 Sheet No: 76 Ref: NX 267 773 (entrance to wood).

Cpt 318
West of the B7027 at Knowe Village, Dumfries and Galloway
OS 1:50,000 Sheet No: 76 Ref: NX 291 720 (entrance to wood).

The sale area is the shaded area on the attached plans.

Summary Estimate of Timber

Compartments	Species	Gross Area (ha)	Tonne s/ha	Average Tree Size	Crop Age	YC	Estimated Tonnage
201-206	SS	13.46	375	0.30	40	18	5,048
202c, 203c	LAR	0.39	200	0.30	28	0	78
318	SS	28.15	375	0.30	52	14	10,556
	Total:	42.00				Total:	15,682

Certification: Timber is FSC 100% and 100% PEFC Certified under reference numbers: SA-FM/COC-0102100-121 and SA-PEFC-FM-COC-010210.

All sale documentation must carry the sale reference of: **Barrhill 2024-1**.

Volumes:	The tonnage has been estimated by the woodland manager.
Access, Extraction and Stacking:	Stacking areas must be agreed with the woodland manager. STTS haul route to Arnimean Bridge and onto the A714 to be used. CTI lorries only. No timber haulage on the B7027.
Hazards:	Hazards are detailed on the attached plan.
Forest Plan Ref:	18FGS26438
Reporting:	The purchaser is required to report monthly to GHAM and a copy of the report template is available on request. The report will require the date, delivery number and tonnes of each load in a spreadsheet format. GHAM will expect to be able to obtain copies of all weight tickets at any point during the contract.
Felling:	All conifers in the sale area should be felled unless instructed by the Woodland Manager. All material above 5cm diameter is to be removed from the site by the purchaser.
Brash:	Brash is to be kept clear of all watercourses during the felling operations. Purchasers should state their proposals for leaving the site clear and ready for replanting following discussion with the Woodland Manager and brash should be cut into lengths of less than 2 metres.
Payment:	Payment terms are to be on a monthly basis with the purchaser producing self billing invoices based on weight tickets, or as otherwise agreed between the parties. A down payment may be payable before entry and offset against the penultimate payment, or as otherwise agreed between the parties.
Contract:	An Agreement will be required to be signed by both parties. A copy is available on request. <i>Although the vendor intends to sell the timber, the vendor will not be bound to accept the highest or any other offer.</i>
Viewing:	The timber may be viewed at any reasonable time during daylight hours, as long as a copy of this document is carried.
Woodland Manager:	Euan Wilkie, Scottish Woodlands Ltd. Mob: 07795 567982 Email: euan.wilkie@scottishwoodlands.co.uk
GH Contact:	Tom Black, Gresham House Mob: 07597 579441 Email: t.black@greshamhouse.com

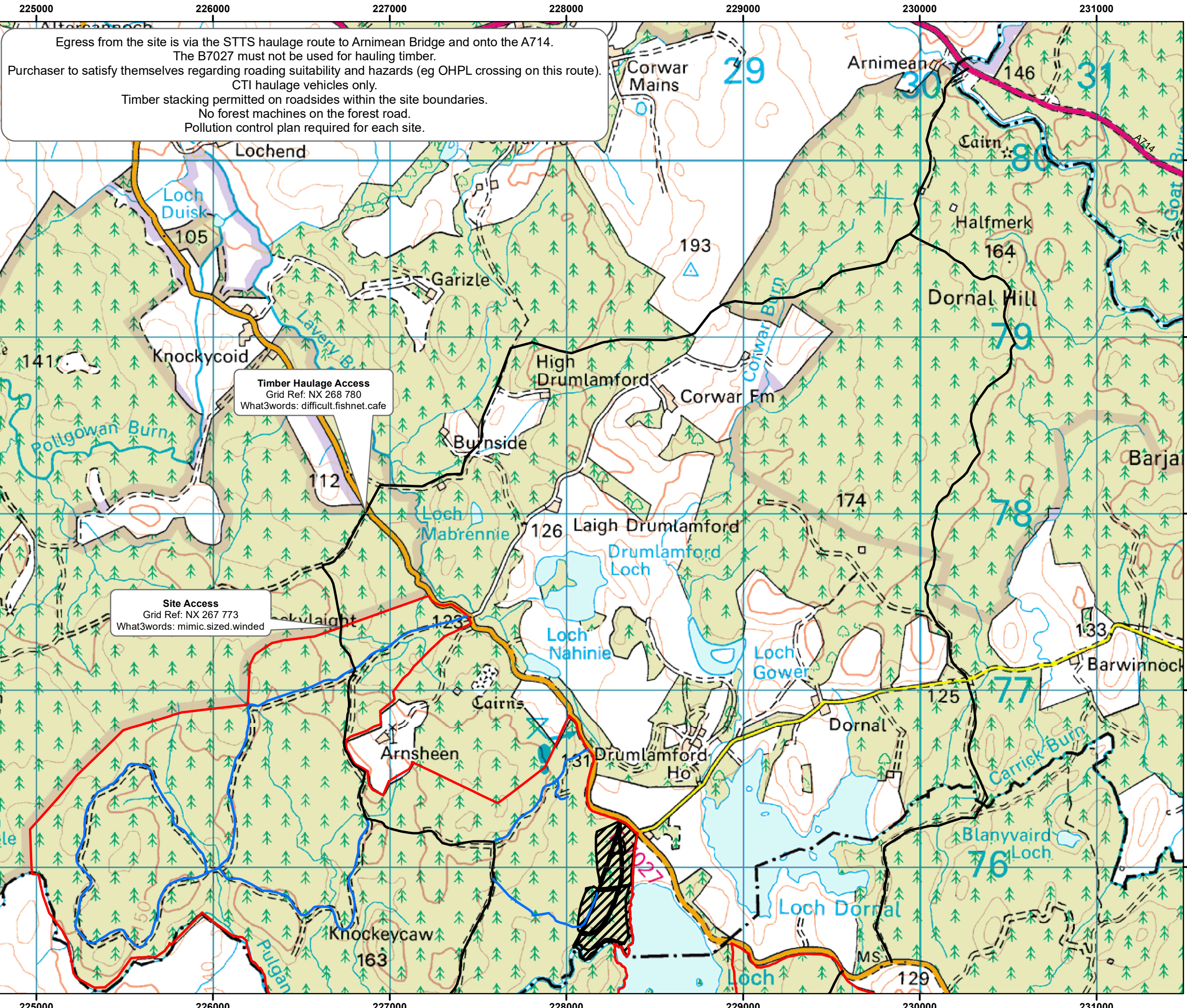

Egress from the site is via the STTS haulage route to Arnimean Bridge and onto the A714.
 The B7027 must not be used for hauling timber.
 Purchaser to satisfy themselves regarding roading suitability and hazards (eg OHPL crossing on this route).
 CTI haulage vehicles only.
 Timber stacking permitted on roadsides within the site boundaries.
 No forest machines on the forest road.
 Pollution control plan required for each site.

Timber Haulage Access
 Grid Ref: NX 268 780
 What3words: difficult.fishnet.cafe

Site Access
 Grid Ref: NX 267 773
 What3words: mimic.sized.winded



Barrhill

Cmp 201-206 Location and Access Map

Created On: December 2022

Legend

- Estate Boundary
- Cmp 201-206
- Infrastructure**
- STTS Road
- Forest Road

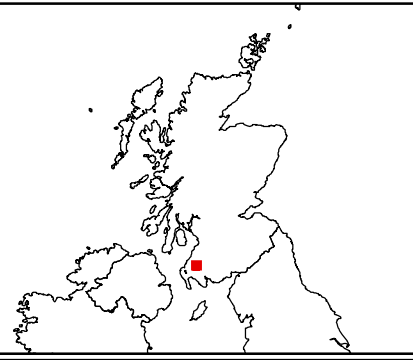

Scottish Woodlands Ltd
 Research Park, Riccarton
 Edinburgh, EH14 4AP

1:20,000
 Scale Correct at A3

© Crown copyright and database rights 2022
 Ordnance Survey 100030835

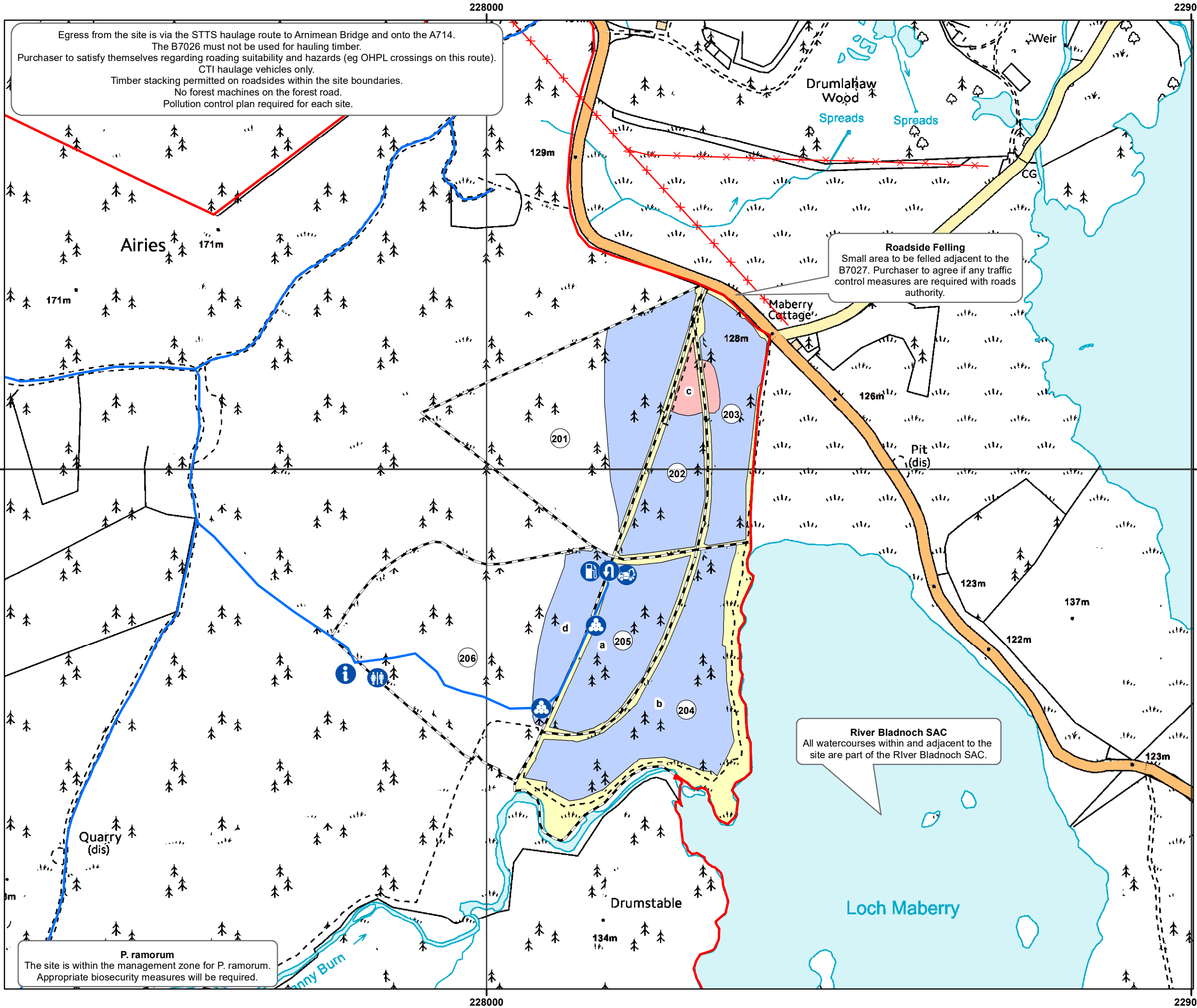

Barrhill

Comp 201-206
Hazards and Constraints Map

Created On: March 2024

Legend

- Estate Boundary
- Compartments
- Infrastructure**
- Forest Road
- Hazards**
- x-x Overhead Powerline
- Species**
- SS
- SPHN Larch
- OG
- Stacking Area
- Welfare
- Fuel Maintenance Point
- Turning Area
- Machine Delivery Point
- Site Information

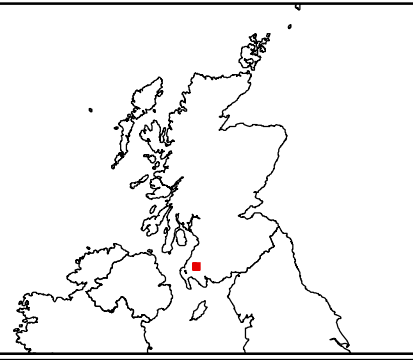





Scottish Woodlands Ltd
Research Park, Riccarton
Edinburgh, EH14 4AP

1:5,000
Scale Correct at A3

© Crown copyright and database rights 2022
Ordnance Survey 100030835

Legend

-  Estate Boundary
-  Cmp 318
- Infrastructure**
-  STTS Road
-  Forest Road

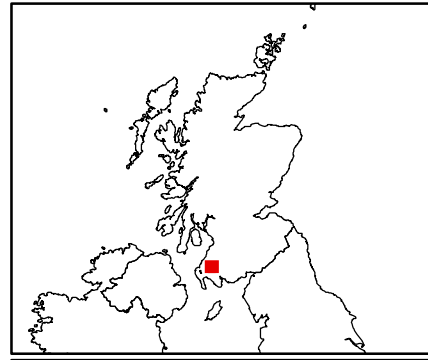

Egress from the site is via the STTS haulage route to Arnimean Bridge and onto the A714.
 The B7027 must not be used for hauling timber.
 Purchaser to satisfy themselves regarding roading suitability and hazards (eg OHPL crossing on this route).
 CTI haulage vehicles only.
 Timber stacking permitted on roadsides within the site boundaries.
 No forest machines on the forest road.
 Pollution control plan required for each site.

Timber Haulage Access
 Grid Ref: NX 295 754
 What3words: prancing.increased.snipe

Site Access
 Grid Ref: NX 290 720
 What3words: hands.promoting.snowballs

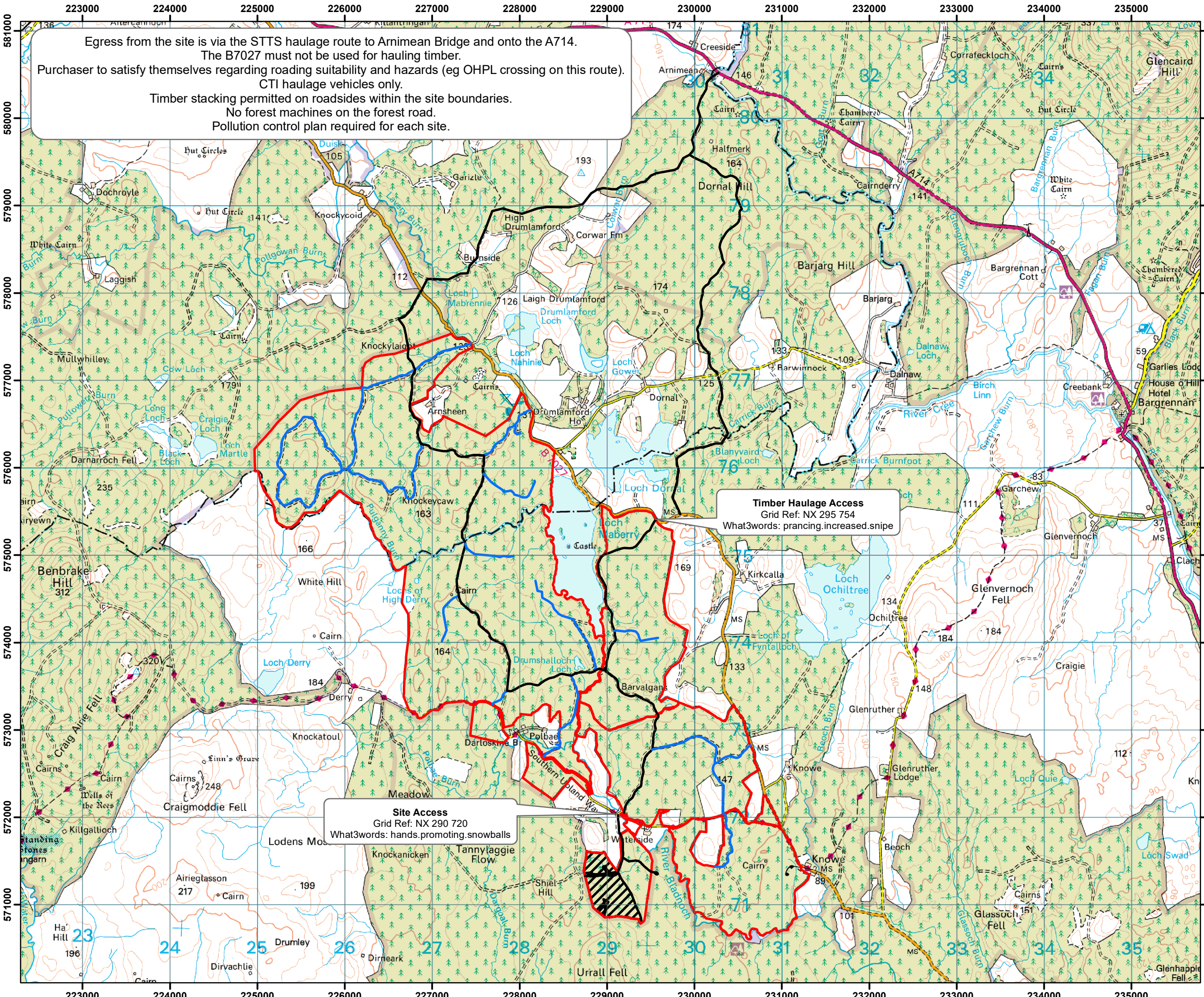

Legend

Estate Boundary

Compartments

Infrastructure

Forest Road

Hazards

Overhead Powerline

Species

SS

OG

Stacking Area

Welfare

Fuel Maintenance Point

Turning Area

Machine Delivery Point

Site Information

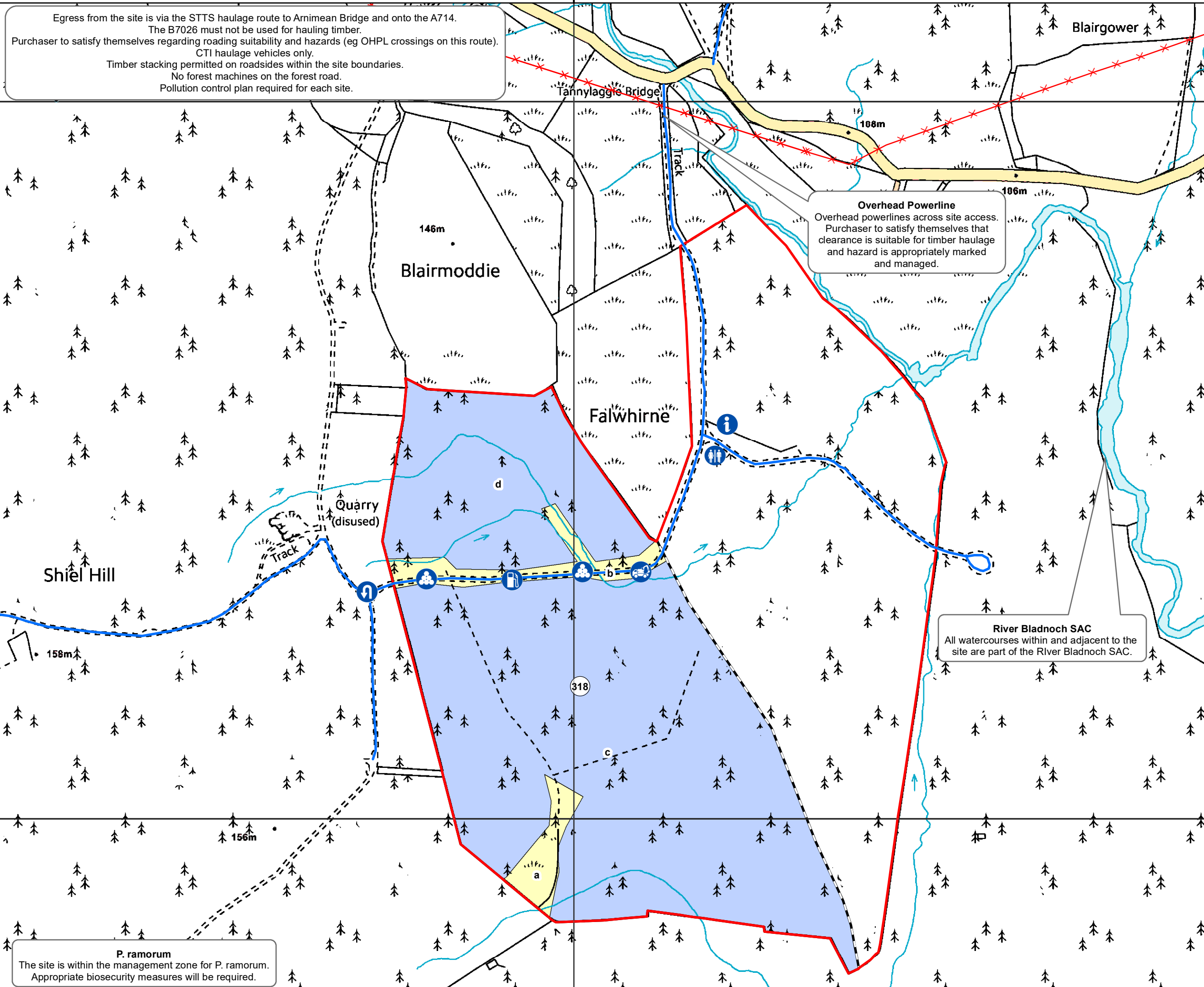
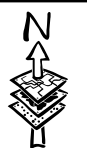
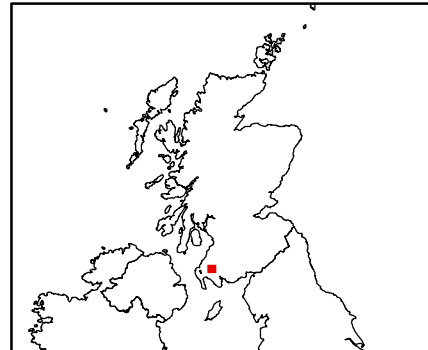

Egress from the site is via the STTS haulage route to Arnimean Bridge and onto the A714.
The B7026 must not be used for hauling timber.
Purchaser to satisfy themselves regarding roading suitability and hazards (eg OHPL crossings on this route).
CTI haulage vehicles only.
Timber stacking permitted on roadsides within the site boundaries.
No forest machines on the forest road.
Pollution control plan required for each site.

Overhead Powerline
Overhead powerlines across site access.
Purchaser to satisfy themselves that clearance is suitable for timber haulage and hazard is appropriately marked and managed.

River Bladnoch SAC
All watercourses within and adjacent to the site are part of the River Bladnoch SAC.

P. ramorum
The site is within the management zone for P. ramorum.
Appropriate biosecurity measures will be required.

572000

572000

571000

571000

229000

229000